



Y₂VP系列变频调速电机

Y₂VP series frequency variable speed regulating motors



地址：中国江苏省靖江市季市西路39号

电话：0086-523-84542453 84542326 84542309

传真：0086-523-84542280 邮编：214523

网址：<http://www.dzem-china.com>

ADD:NO.39,JISHI,JINGJIANG CITY,JIANGSU,CHINA

TEL:0086-523-84542453 84542326 84542309

FAX:0086-523-84542280 POST CODE:214523

E-mail:jidzjd@pub.tz.jsinfo.net

江苏大中电机股份有限公司

概述 Introduction

Y₂VP系列变频调速电机吸收了国内外先进企业之优点，应用计算机辅助设计技术进行设计。可与国内外同类型变频装置配套，互换性、通用性强。电机采用鼠笼型结构，运行可靠，维护方便。电机单独装有轴流风机，保证电机在不同转速下均有较好的冷却效果。电机绝缘采用国际上广为使用的F级绝缘结构，提高了电机的可靠性。电机的功率、底脚安装尺寸和中心高等对应指标与Y或Y₂异步电机完全一致。

本系列电机可广泛应用于轻工、纺织、化工、冶金、机床等需要调速转动装置的行业中，是一种理想的调速动力源。

本系列电机功率从0.55千瓦-900千瓦，机座中心高从80毫米-450毫米。

Adopted the advantages of the same-type motors of industry-advanced countries such as YVP Series Motors are designed with computer assistant technology.It can be coordinated with the sametype frequency converter at home and abroad.So it has a good interchangeability and commonality.In addition,it has used a squirrel-cage construction for reliable operation and easy maintenance.Separtely assembled with axial-flow ventilator,YVP Series Motors can guatantee its better cooling effect at different speeds.It has adopted Class F insulation system widely applied in the world to improve its reliability.Its output,foot-mounting dimensions and central height are in correspondence with that of Y or Y₂ Series Motors.

Y₂VP Series Motors can be widely applied for driven equipment in need of velocity modulation in light industry,textile,chemical,metallurguical and machine tool industries and are an ideal power source of velocity modulation.

The output of this series motors ranges from 0.55kw to 900kw and the frame central height ranges from 80mm to 450mm.

型号说明 Type Designation

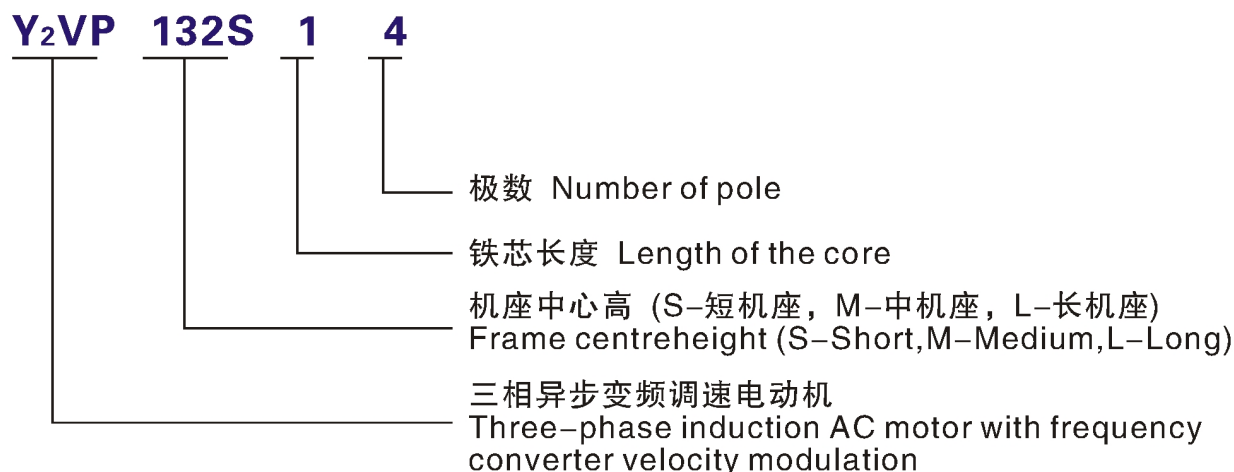

Y₂VP 系列 变频调速电机

Y₂VP series frequency variable speed regulating motors

主要技术性能

Major Performance

- ❖ 工作方式: S1 Duty: S1
- ❖ 电压: 三相380伏 (50赫兹或60赫兹) Voltage three phase 380v(50Hz or 60Hz)
- ❖ 变频调速范围: 5-100赫兹无极调速。50赫兹 (60赫兹) 以下为恒转矩调速; 50赫兹 (60赫兹) 以上为恒功率调速。 Range of frequency converter velocity modulation 5-100Hz stepless velocity modulation bellow 50Hz(or 60Hz)velocity modulating over 50Hz(or 60Hz) with constant torque velocity modulating with constant output.
- ❖ 电机能承受额定转矩的160%过载, 历时1分钟。 The motor can undergo overload of 160% at rated rotor torque for 1 mi nute.
- ❖ 低速时转矩平滑, 无爬行现象。 The motor torque appears as smooth at lower speed and the motor runs without creep.
- ❖ 能通过变频装置的电压提升, 保证电动机在5赫兹时输出额定转矩而不致使电机因发热而烧毁。 The motor can guarantee rated rotor torque output at frequency or 5Hz by voltage rising of frequency converter device and not go so far as to be burned as heating.
- ❖ 绝缘等级: F级 Insulation: F calss.
- ❖ 防护等级: 电机IP54 (或IP55); 轴流风机IP54 Protection: IP54 or IP55(motor); IP54(axial flow ventilator).

安装结构型式

Mounting Arrangements(IM)

- ❖ B3机座带底脚, 端盖无凸缘。 B3 With feet and without flange on the end-shield.
- ❖ B5机座不带底脚, 端盖有凸缘。 B5 Without feet and with flange on the end-shield.
- ❖ B35机座带底脚, 端盖有凸缘。 B35 With feet and with flange on the end-s shield.

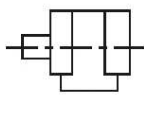
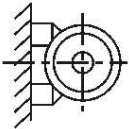
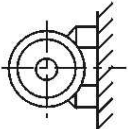
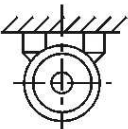
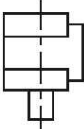
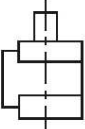
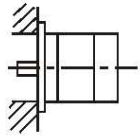
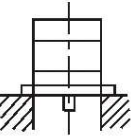
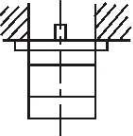
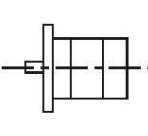
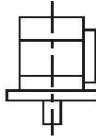
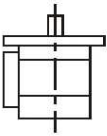
基本结构型式 Fundamental arrangement	B3					
安装结构型式 Mounting arrangement	B3	B6	B7	B8	V5	V6
示意图 Diagram						
基本结构型式 Fundamental arrangement	B5			B35		
安装结构型式 Mounting arrangement	B5	V1	V3	B35	V15	V36
示意图 Diagram						

安装及外形尺寸 Overall Dimensions

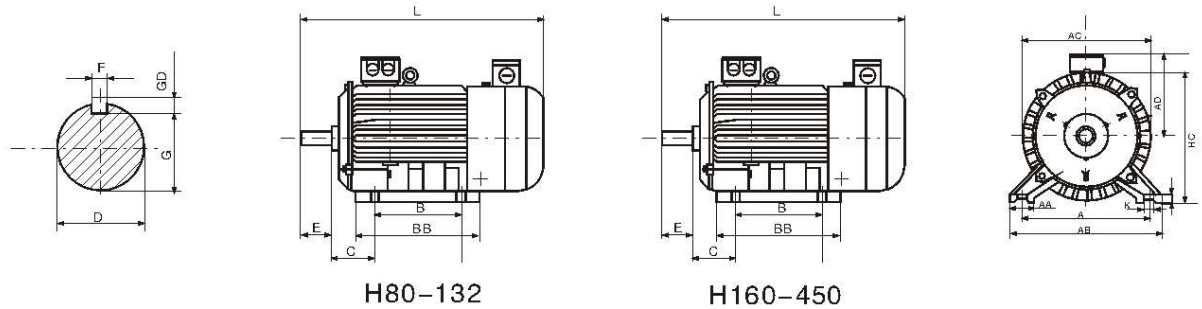

H80-132

H160-450

B3

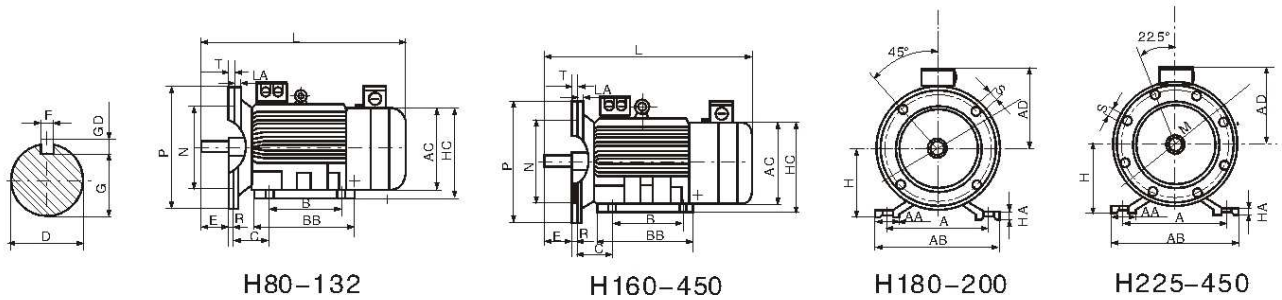

H80-132

H160-450

H180-200

H225-450

B35

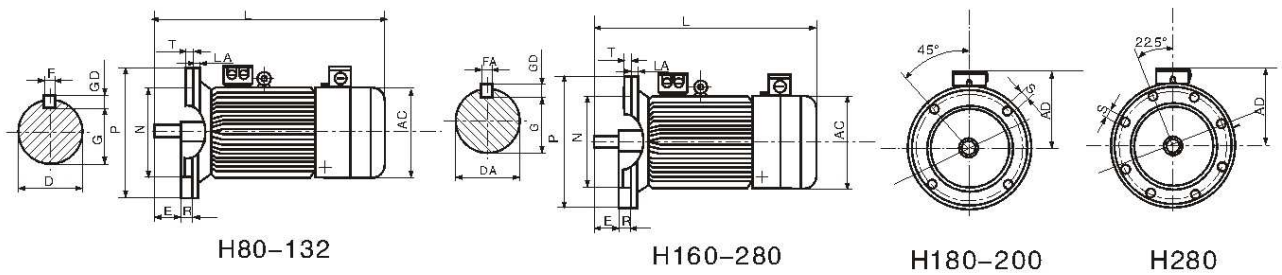

H80-132

H160-280

H180-200

H280

B5

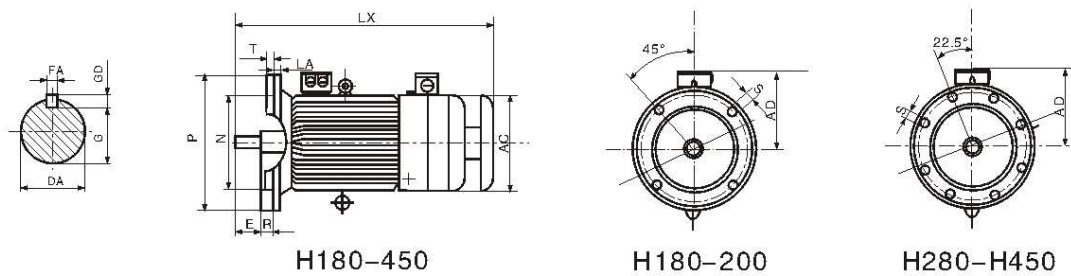

H180-450

H180-200

H280-H450

V1

Y₂VP 系列变频调速电机

Y₂VP series frequency variable speed regulating motors

轴承型号、出线孔尺寸 Bearing model, conduit hole dimension

轴承型号 Bearing model					
型号 model	极数 Pole Number	D-end		N-end	
80M	2,4	6204	RZ	6204	RZ
90S	2,4,6	6205	RZ	6205	RZ
90L	2,4,6	6205	RZ	6205	RZ
100L	2,4,6	6206	RZ	6206	RZ
112M	2,4,6	6206	RZ	6206	RZ
132S	2,4,6,8	6208	RZ	6208	RZ
132M	2,4,6,8	6208	RZ	6208	RZ
160M	2,4,6,8	6309	C3	6309	C3
160L	2,4,6,8	6309	C3	6309	C3
180M	2,4,6,8	6311	C3	6311	C3
180L	2,4,6,8	6311	C3	6311	C3
200L	2,4,6,8	6312	C3	6312	C3
225S	4,6,8	6313	C3	6313	C3
225M	2	6312	C3	6312	C3
225M	4,6,8	6313	C3	6313	C3
250M	2	6314	C3	6314	C3
250M	4,6,8	6314	C3	6314	C3
280S	2	6316	C3	6316	C3
280S	4,6,8	6316	C3	6316	C3
280M	2	6316	C3	6316	C3
280M	4,6,8	6316	C3	6316	C3
315S	2	6316	C3	6316/C3VL0241	C3
315S	4,6,8	NU319	C3	6319/C3VL0241	C3
315M	2	6316	C3	6316/C3VL0241	C3
315M	4,6,8	NU319	C3	6319/C3VL0241	C3
315L	2	6316	C3	6316/C3VL0241	C3
315L	4,6,8	NU319	C3	6319/C3VL0241	C3
355M	2	6317	C3	6319/C3VL0241	C3
355M	4,6,8	NU322	C3	6319/C3VL0241	C3
355L	2	6319	C3	6319/C3VL0241	C3
355L	4,6,8	NU 322	C3	6319/C3VL0241	C3
355XL	2	NU219+6219	C4	NU219/C3VL0241	C4
355XL	4, 6, 8	NU224+6224	C3	NU224/C3VL0241	C3
400L	2	NU219+6219	C4	NU219/C3VL0241	C4
400L	4, 6, 8	NU226+6226	C3	NU226/C3VL0241	C3
450L	2	NU222+6222	C4	NU222/C3VL0241	C4
450L	4, 6, 8	NU228+6228	C3	NU228/C3VL0241	C3

Y₂VP 系列变频调速电机

Y₂VP series frequency variable speed regulating motors

型号 model	P	A	AA	AB	AC	B	BB	C	D	E	F	G	GD	H	HA	K	L	LA	M	N	P	S	T	LX
80	2-4	125	34	165	175	100	135	50	19	40	6	15.5	6	80	10	10	400	12	165	130	200	12	3.5	-
90S	2-6	140	36	180	195	100	140	56	24	50	8	20	7	90	12	10	410	12	165	130	200	12	3.5	-
90L	2-6	140	36	180	195	125	165	56	24	50	8	20	7	90	12	10	435	12	165	130	200	12	3.5	-
100L	2-6	160	40	205	215	140	185	63	28	60	8	24	7	100	12	12	490	13	215	180	250	14.5	4	-
112M	2-6	190	45	230	240	140	180	70	28	60	8	24	7	112	15	12	500	14	215	180	250	14.5	4	-
132S	2-8	216	55	270	275	140	190	89	38	80	10	33	8	132	18	12	550	14	265	230	300	14.5	4	-
132M	2-8	216	55	270	275	178	230	89	38	80	10	33	8	132	18	12	590	14	265	230	300	14.5	4	-
160M	2-8	254	65	320	330	210	260	108	42	110	12	37	8	160	20	14.5	700	15	300	250	350	18.5	5	-
160L	2-8	254	65	320	330	254	304	108	42	110	12	37	8	160	20	14.5	755	15	300	250	350	18.5	5	-
180M	2-4	279	70	355	380	241	315	121	48	110	14	42.5	9	180	22	14.5	805	15	300	250	350	18.5	5	865
180L	4-8	279	70	355	380	279	355	121	48	110	14	42.5	9	180	22	14.5	845	15	300	250	350	18.5	5	905
200L	2-8	318	70	395	420	305	375	133	55	110	16	49	10	200	25	18.5	900	17	350	300	400	18.5	5	970
225S	4-8	356	75	435	470	286	375	149	60	140	18	53	11	225	28	18.5	925	20	400	350	450	18.5	5	980
225M	2	356	75	435	470	311	395	149	55	110	16	49	10	225	28	18.5	950	20	400	350	450	18.5	5	975
225M	4-8	356	75	435	470	311	395	149	60	140	18	53	11	225	28	18.5	950	20	400	350	450	18.5	5	1005
250M	2	406	80	490	510	349	445	168	60	140	18	53	11	250	30	24	1016	22	500	450	550	18.5	5	1115
250M	4-8	406	80	490	510	349	445	168	65	140	18	58	11	250	30	24	1016	22	500	450	550	18.5	5	1115
280S	2	457	85	550	560	368	490	190	65	140	18	58	11	280	35	24	1105	22	500	450	550	18.5	5	1105
280S	4-8	457	85	550	560	368	490	190	75	140	20	67.5	12	280	35	24	1105	22	500	450	550	18.5	5	1105
280M	2	457	85	550	560	419	540	190	65	140	18	58	11	280	35	24	1160	22	500	450	550	18.5	5	1160
280M	4-8	457	85	550	560	419	540	190	75	140	20	67.5	12	280	35	24	1160	22	500	450	550	18.5	5	1160
315S	2	508	120	630	645	406	570	216	65	140	18	58	11	315	45	28	1275	24	600	550	660	24	6	1400
315S	4-8	508	120	630	645	406	570	216	80	170	22	71	14	315	45	28	1305	24	600	550	660	24	6	1430
315M	2	508	120	630	645	457	680	216	65	140	18	58	11	315	45	28	1385	24	600	550	660	24	6	1510
315M	4-8	508	120	630	645	457	680	216	80	170	22	71	14	315	45	28	1415	24	600	550	660	24	6	1540
315L	2	508	120	630	645	508	680	216	65	140	18	58	11	315	45	28	1385	24	600	550	660	24	6	1510
315L	4-8	508	120	630	645	508	680	216	80	170	22	71	14	315	45	28	1415	24	600	550	660	24	6	1540
355M	2	610	120	730	710	560	760	254	75	140	20	67.5	12	355	52	28	1650	24	740	680	800	24	6	1760
355M	4-10	610	120	730	710	560	760	254	95	170	25	86	14	355	52	28	1680	25	740	680	800	24	6	1790
355L	2	610	120	730	710	630	760	254	75	140	20	67.5	12	355	52	28	1650	25	740	680	800	24	6	1760
355L	4-10	610	120	730	710	630	760	254	95	170	25	86	14	355	52	28	1680	25	740	680	800	24	6	1790
355XL	2	630	135	760	770	800	1140	224	80	170	22	71	14	355	52	35	2030	28	840	780	900	24	6	2080
355XL	4	630	135	760	770	800	1140	224	110	210	28	100	16	355	52	35	2080	28	840	780	900	24	6	2130
400L $\frac{1}{2}$	2	686	125	812	810	$\frac{686}{1000}$	1095	224	85	170	22	76	14	400	52	35	1910	28	940	880	1000	28	6	1960
400L $\frac{1}{2}$	4-8	686	125	812	810	$\frac{686}{1000}$	1095	224	120	210	32	109	18	400	52	35	1950	28	940	880	1000	28	6	2000
400 $\frac{L3}{L4}$	2	710	135	840	860	900	1140	224	85	170	22	76	14	400	52	35	2110	28	940	880	1000	28	6	2060
400 $\frac{L3}{L4}$	4-8	710	135	840	860	900	1140	224	120	210	32	109	18	400	52	35	2075	28	940	880	1000	28	6	2125
450L	2	800	190	990	960	1000	1300	250	95	170	25	86	14	450	52	42	2270	33	1080	1000	1150	28	6	2320
450L	4-10	800	190	990	960	1000	1300	250	130	210	32	119	18	450	52	42	2350	33	1080	1000	1150	28	6	2400

注：L尺寸为不带编码器时的尺寸。 Note: Dimension L is the size without encoder.

Y₂VP 系列 变频调速电机

Y₂VP series frequency variable speed regulating motors

额定转矩、标称功率与调频范围的对应关系表

Corresponding relation sheet of rated torque, nominal power and frequency modulation range

功率 power (kw)	同步转速 synchronous rotation(r/min) 3000 额定转矩 rated torque(N-m)	恒转矩 调频范围 frequency modulation range of constant torque (Hz)	恒功率 调频范围 frequency modulation range of constant power (Hz)	同步转速 synchronous rotation(r/min)			恒转矩 调频范围 frequency modulation range of constant torque (Hz)	恒功率 调频范围 frequency modulation range of constant power (Hz)				
				1500	1000	750						
				额定转矩 rated torque(N-m)								
-	-			-	-	-						
-	-			-	-	-						
0.55	-	5-50	50-100	3.5	5.25		5-50	50-100				
0.75	2.4			4.8	7.2	9.6						
1.1	3.5			7.0	10.5	14.0						
1.5	4.8			9.6	14.3	19.1						
2.2	7.0			14.0	21.0	28.0						
3	9.6			19.1	28.7	38.2						
4	12.7			25.5	38.2	50.9						
5.5	17.5			35.0	52.5	70.0						
7.5	23.9			47.8	71.6	95.5						
11	35.0			5-50	50-80	70.0			105.1	140.1	5-50	50-100
15	47.8	95.5	143.3			191.0						
18.5	58.9	117.8	176.7			235.6						
22	70.0	140.1	210.1			280.1						
30	95.5	191.0	286.5			382.0						
37	117.8	235.6	353.4			471.1						
45	143.3	286.5	429.8			573.0						
55	175.1	350.2	525.3			700.3						
75	238.8	5-50	50-60			477.5	716.3	955.0	5-50	50-100		
90	286.5					573.0	859.5	1146.0				
110	350.2			700.3	1050.5	1400.7						
132	420.2			840.4	1260.6	1680.8						
160	509.3			1018.7	1528.0	2037.3						
200	636.7			1273.3	1910.0	2546.7						
250	795.8			1591.7	2387.5	3183.3						
315	1002.8			2005.5	3008.2	4011.0						
355	1130.0			2260.2	3390.2	4520.3						
400	1273.3			2546.7	3820.0	5093.3						
450	1432.5	2865.0	4297.5	5730.0								
500	1591.7	3183.3	4775.0	6366.7								
560	1782.7	3565.3	5348.0	7130.7								
630	2005.5	4011.0	6016.5	-								
710	2260.2	4520.3	6780.5	-								
800	2546.7	2093.3	-	-								
900	-	5730.0	-	-								

机座号 machine base number	80-132	>132-225	>225-450
振动速度 oscillation speed (mm/s)	1.8	2.8	3.5

功率与机座号的对应关系表 Corresponding relation sheet between power and machine base number.

机座号 machine base number	同步转速 synchronous rotation(r/min)			
	3000	1500	1000	750
功率 power(kw)				
801	0.75	0.55	-	-
802	1.1	0.75	-	-
90S	1.5	1.1	0.75	-
90L	2.2	1.5	1.1	-
100L1	3	2.2	1.5	-
100L2		3		-
112M	4	4	2.2	-
132S1	5.5	5.5	3	2.2
132S2	7.5			
132M1	-	7.5	4	3
132M2			5.5	
160M1	11	11	7.5	4
160M2	15		5.5	
160L	18.5	15	11	7.5
180M	22	18.5	-	-
180L	-	22	15	11
200L1	30	30	18.5	15
200L2	37		22	
225S	-	37	-	18.5
225M	45	45	30	22
250M	55	55	37	30
280S	75	75	45	37
280M	90	90	55	45
315S	110	110	75	55
315M	132	132	90	75
315L1	160	160	110	90
315L2	(185)200	(185)200	132	110
355M1	220	220	160	132
355M2	250	250	(185)200	160
355L	(280)315	(280)315	(220)250	200
355XL1	355	355	315	250
355XL2	400	400	355	315
355XL3	450	450	-	-
400L1	450	450	355	315
400L2	500	500	400	355
400L3	560	560	450	400
400L4	-	630	500	-
450L1	(560)	(630)	(500)	(400)
450L2	630	710	560	450
450L3	710	800	630	500
450L4	800	900	710	560

注：S、M、L后面的数字1、2分别代表同一机座号和转速下不同的功率。
Remark: 1,2 following S, M, L respectively denote different powers at a machine base number and rotary speed.

噪音表 sound meter

功率 power (kw)	同步转速 synchronous rotation(r/min)			
	3000	1500	1000	750
	声功率级 Sound power rating dB(A)			
0.18	-	-	-	62
0.25	-	-	-	62
0.37	-	-	64	66
0.55	-	68	64	66
0.75	77	68	67	69
1.1	77	71	67	69
1.5	82	71	71	71
2.2	82	74	75	74
3	86	74	79	74
4	87	75	79	78
5.5	90	81	79	78
7.5	90	81	83	78
11	96	85	83	80
15	96	85	83	83
18.5	96	86	86	83
22	99	86	86	83
30	102	89	86	85
37	102	91	88	86
45	102	91	90	86
55	103	93	90	92
75	104	96	95	92
90	104	96	95	92
110	106	103	95	92
132	106	103	95	100
160	109	107	102	100
185	109	107	102	100
200	109	107	102	100
250	113	111	102	105
280	113	111	108	105
315	113	111	108	105
355	114	112	108	105
400	118	115	112	109
450	118	115	112	109
500	118	118	115	109
560	119	118	115	112
630	119	118	115	112
710	119	118	115	112
800	119	118	115	112
900	119	118	115	112

轴流风机功率、电流、风量、出线孔 Axial-flow fan power, current, air flow, conduit hole

	电制 electrical braking	功率 power (w)	风量 air flow (m ³ /h)	电流 current (A)
G-80A	三相380V,50Hz	60	350	0.24
G-90A	三相380V,50Hz	60	500	0.24
G-100A	三相380V,50Hz	60	650	0.24
G-112A	三相380V,50Hz	60	1000	0.24
G-132A	三相380V,50Hz	40/60	450/1000	0.21/0.24
G-160A	三相380V,50Hz	40	960	0.21
G-180A	三相380V,50Hz	230	1200	0.71
G-200A	三相380V,50Hz	230	1800	0.71
G-225A	三相380V,50Hz	230	2750	0.71
G-250A	三相380V,50Hz	230	3300	0.71
G-280A	三相380V,50Hz	370	4000	1.2
G-315A	三相380V,50Hz	450	5200	1.5
G-355A	三相380V,50Hz	600	6000	1.9
G-355XLA	三相380V,50Hz	600	6000	1.9
G-400A	三相380V,50Hz	700/1100	6200/9000	2.2/2.32
G-450A	三相380V,50Hz	2200	8000	5.16

型号 model	出线孔 conduit hole
Y2VP80-450	M20×1.5



说明：1、H355XL~H450L机座为低压大功率变频电机，此样本中参数仅作参考，以订货协议及外型图中的性能参数及安装尺寸为准。

2、额定电压、频率或调频范围，冷却方式等具有特殊要求的订货，以双方进行的技术协议为准。

Note: 1) H355XL~H450L engine case is low-voltage large power frequency conversion motor, the parameter of this catalogue is only for reference, the performance parameter & installation dimension of purchasing agreement and external diagram should be taken as valid and binding.

2) For ordering with special requirement such as rated voltage, frequency or frequency modulation range, cooling method etc, it is subject to the mutual technical agreement.